

FILTER CONTROLLER

The eMiniFlush is Filter Back Flush Controller is designed to specifically for controlling all types of Agricultural & Industrial filters. Suitable for flushing 1-5 Filters. (4 Filters if Master Valve in use) Including:

- * Sand/Media
- * Screen
- * Disk/Sprinkin
- * Self-Cleaning Automatic

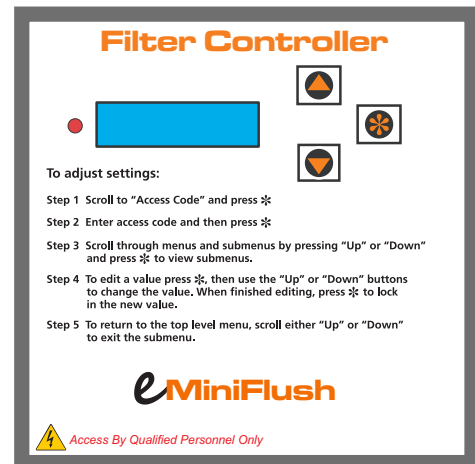

DESCRIPTION

The Five Filter Flush Controller is designed to automatically back flush filters on either a time, via an external input or optional differential pressure sensor. The unit is supplied in a PVC IP 65 enclosure which includes an alpha numeric display and a 3 button keypad to allow the user to implement an extensive array of options typically required by existing filter manufacturers.

FEATURES

- * Capable of back flushing up to 5 Filters.
- * Master Output Valve as standard.
- * Back flush activation mode:
 - * DP sensor (Analog)
 - * External DP (Switch)
 - * Time Based (Programmable)
- * Power Options.
 - * Replaceable Batteries.
 - * 110vAC or 220VAC
- * IP65 Polycarbonate Enclosure
- * Real English Menus with 2 Line LCD display.
- * Two Programmable Inputs
 - * Stop Back Flush
 - * Start Back Flush
 - * Excessive Backflush
 - * Pause Back Flush
 - * Fault Reset
 - * Loss of Flow
- * Valve Options
 - * 12vDC 2 Wire Latching. (Battery Power)
 - * 24VAC, 12vDC, 12vDC 2 Wire Latching



DETAILED FEATURES

* Programmable Delays

- * Between Master valve and first valve.
- * Between each filter.
- * Input activation.
- * Filter loss of flow detection.
- * Excessive back flush flow detection.

* Programmable Outputs

Unused valve outputs are programmable

- * Fault.
- * No Fault.
- * Back flushing On.
- * Not Back Flushing.
- * Filter Duplication.

* Fault Detection

- * Maximum allowable back flushes per hour.
- * Maximum consecutive back flush attempts by DP input.

* Options

- * Contact Techsys for further options.

* Data Logging

- * Back Flush Count.
- * Interval Back flushes
- * External Back Flushes Count.
- * Interval Back Flushes Last Hour
- * External Back Flushes Last Hour
- * Last interval Back Flush.
- * Last External Back Flush.
- * Total Back Flushes on Time.
- * Controller Run Time.
- * Time since last Power up.
- * Data Log Reset Function.

* Scada/BMS (Optional)

- * RS485 Modbus (2 wire)

SPECIFICATIONS

Power input	12VDC, 24VAC, 240vAC
Input power frequency – AC Voltage	48-62Hz
Maximum power output	40 watt
Temperature range	-5 to 60degC
Relative humidity range	to 90% non-condensing
Enclosure rating	IP65
Output Relay	3 amp rating Mechanical life 20 x 10⁶ cycles Electrical life 1 x 10⁵ cycles
Enclosure Size	150mm X 150mm X 80mm



Product performance specifications may change without notice.